

NAUTITECH 40 OPEN

TECHNICAL STANDARD SPECIFICATIONS

AUGUST 10th 2018



TECHNICAL DATAS

Length overall	11,98 m / 39'3"
Length waterline	11,94 m / 39'2"
Beam overall	6,91 m / 22'7"
Draft	1,35 m / 4'4"
Unloaded weight (approx.)	8,5 t / 18 739 lbs
Engine, drive	VP D2-20, Saildrive
Engine power	2 x 20 hp
Fuel tank	2 x 215 L / 2 x 57 gal
Water tank	2 x 215 L / 2 x 57 gal
Cabins - Heads, standard	3 or 4 - 2
Berths, standard version	6 or 8
Full batten mainsail, standard	63 sqm / 678 sq ft
Self-tacking jib, standard	28 sqm / 301 sq ft
Height of mast above water line (approx.)	20,05 m / 65'8"
Architect	Marc Lombard
Interior Design	Roseo Design

CE-Certification Category A [10 Pers.]

CE-Certification Category B [10 Pers.]

CE-Certification Category C [22 Pers.]

CE-Certification Category D [22 Pers.]



CONSTRUCTION

Hull and Deck made of fibreglass and polyester sandwich infusion- BAVARIA VacuTec process	■
Hull and Deck in gelcoat white, coachroof in gelcoat light grey	■
Keel in GRP laminated and bonded to hull	■
6 x Hull windows including opening porthole	■

RIG AND DECK HARDWARE

Aluminium deck stepped mast, anodised, with two spreaders sets	■
Aluminium boom, anodised	■
Anodized aluminium forward front beam	■
Running rigging	■
Mainsheet traveller on the coachroof	■
4 x Lewmar Evo aluminium winches 2-gear, self-tailing , 3 in cockpit, 1 at mast foot	■
2 x Winch handles and pockets	■

SAILS

Full batten mainsail [2 reef lines], Dacron	■
Self-tacking Solent in Dacron, incl. UV protection [Grey]	■

DECK/ STERN PLATFORM

Guardrail on hull sides with stainless steel wires	■
2 x Forward pulpits with seats in teak	■
6 x Mooring cleats, aluminium	■
Anodised aluminium forward beam with integrated anchor roller	■
Two net lashed to hull and front beam	■
Bow anchor locker and storage	■
8 x openable deck hatches [1 additional in the 3 cabin version]	■

PROPULSION / STEERING

2 x 20hp diesel engines Volvo Penta [Saildrive]	■
2 x 3-blade fixed aluminium propellers	■
Two helmstand with compass and stainless wheels, leather covered	■
GRP rudders with stainless steel stock	■
Emergency tiller	■
Access to engine room via transom hatches	■

ELECTRICAL MANAGEMENT SYSTEM

9" Digital Switching System incl. multifunction display at chart table for 12V System	■
Alternators 115Ah [1 x per engine]	■
1 battery per engine 12V/90Ah	■
Battery for service 1 x 12V/107Ah [gel]	■
Electrical switch for batteries [service and engines]	■

LIGHTS

LED navigation lights and anchor light	■
Spot LED ceilinglights in cabins, bathrooms	■
Dimmable ceiling LED strips ceilinglights in saloon and cockpit	■

PLUMBING

Electric and manual bilge pumps in both hulls	■
Electric bilge pumps in both engine compartments	■
2 x 215L freshwater tanks	■
Freshwatersystem with electrical pressure pump	■

COCKPIT / TRANSOM

Spacious open style cockpit, 2 large benches on starboard and portside	■
Aft bench with storage	■
Double sliding door to salon	■
Teak grating over cockpit drainage	■
Large cockpit lockers	■
Aft pushpits	■
Foldable bathing ladder on starboard	■

INTERIOR LAYOUTS

Available versions

4 Cabins

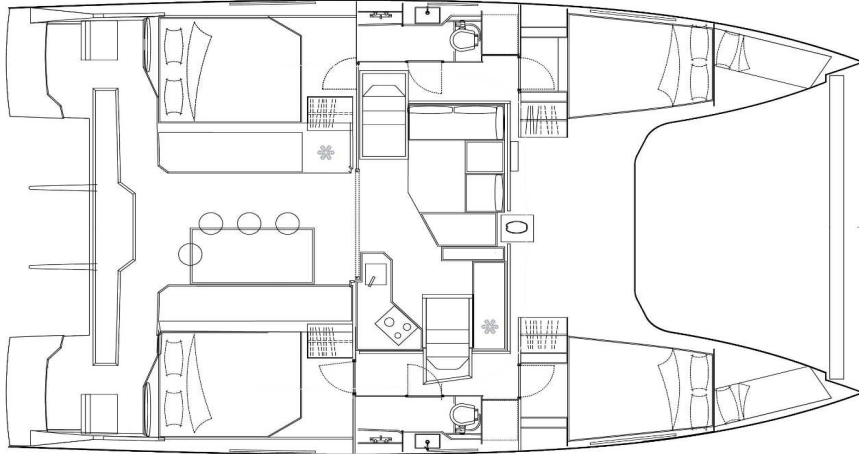

3 Cabins - Owner Version

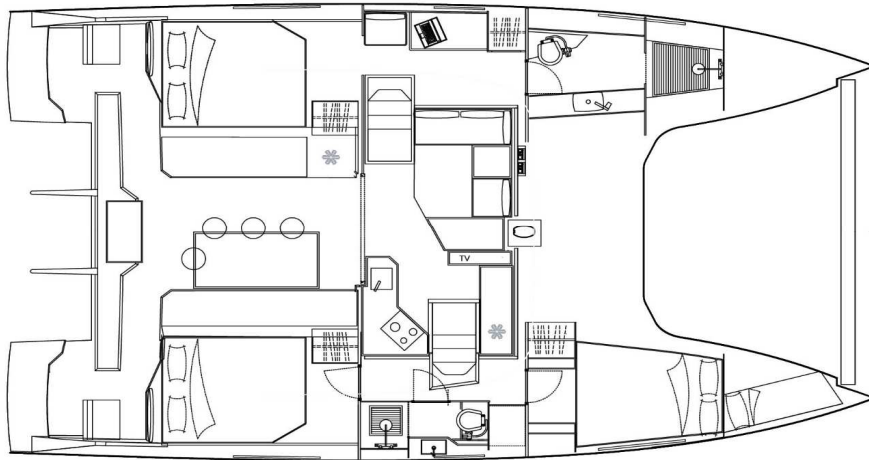

Generalities

Interior woodwork in Alpi White oak
Resopal Elm Flooring
GRP - Quartz Grey
Headliner Silvertex ICE



Saloon

Comfortable saloon area with modern lounge style sofas
Chart table, height adjustable with instrument console
Fabric upholstery : see 'Comfort' range
LED reading lights at the chart table
Central storage drawer for bottles
2 x opening roof hatches



Galley

Multiple storage cupboards
Large worktop (standard HPL)
Aft galley with :
Gas oven
3 burner gas stove
Single sink with mixer tap
Waste bin
Overhead locker in galley, starboard



Cabins

Aft cabins with Double bed [160*200cm]
Forward cabins with Double bed [150*195cm]
Mattresses Light Grey with washable cover
Storage locker in hull passageway
Double hull windows in each cabin
Side lining around the window White
Head Side, Liners, Bed Surround, Head Board ICE and Macadamia silvertex
Several spacious lockers and shelves for storage
LED reading lights headboard

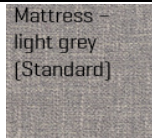

Mattress –
light grey
[Standard]



Owner Cabins equipment (in addition to above cabin description)

Access from the saloon through a sliding door
Working area : Fold down desk with seat
Shelf on outer side of hull
Large lockers with three doors



Head stb

Sink with mixing tap
Black worktop
Cabinet for storage
Towel rail
Mirror
Holding tank 45L [one per hull]
Pump-toilet, manual
Opening portlight in hull window
Opening deck hatch



Owner head

Separate shower cabin
Black worktop
Cabinet for storage
Mirror
Towel rail
Sink with mixing tap
Holding tank 45L [one per hull]
Manual pump toilet, disposal via seacock
Opening portlight in hull window
2 x Opening deck hatch [above shower cabin and bathroom]



All weights and measurements are calculation based upon construction documents. The brochure is intended for advertisement only and is not part of a contract, warranty or of an offer. We reserve the right to modify or improve our products and to change its specifications without notice. We are not liable for errors and printing mistakes. All rights are reserved to execute alterations in construction and equipment without notice. Aforementioned prices are recommended sales prices for deliveries ex works within 4 months of order placement. Later deliveries are subject to invoicing according to the then valid price list.

Version 2/2018 - Valid as of August 10th 2018

Date of issue : August 10th 2018 - the previous price list loses its validity.

