



C45



TECHNICAL DATA [approx.]

C45

Length over all	14,06 m	46,12 ft
Length over all incl. bowsprit	14,44 m	47,37 ft
Length hull	13,60 m	44,61 ft
Length waterline	12,94 m	42,45 ft
Beam of hull	4,49 m	14,73 ft
Draught standard	2,20 m	7,21 ft
Draught option	1,75 m	5,74 ft
Ballast standard	2.984 kg	6.578 lb
Ballast option	3.370 kg	7.429 lb
Displacement standard	12.222 kg	26.944 lb
Displacement option	13.181 kg	29.059 lb
Engine [standard]	41,9 kW / 57 PS	41,9 kW / 57 hp
Engine [standard]	Yanmar 4JH57	Yanmar 4JH57
Engine [option]	58,8 kW / 80 PS	58,8 kW / 80 hp
Engine [option]	Yanmar 4JH80	Yanmar 4JH80
Fuel tank [approx.]	244 L	64 gal
Water tank [approx.]	310 L [554 L]	82 gal [146 gal]
Sail area total [standard]	109,0 m ²	1173,2 sq.ft
Mainsail [standard]	64,0 m ²	688,8 sq.ft
Mainsail [furling]	51,0 m ²	548,9 sq.ft
Jib	45,0 m ²	484,3 sq.ft
Genoa	52,0 m ²	559,7 sq.ft
Gennaker	170,0 m ²	1829,8 sq.ft
Code 0	96,0 m ²	1033,3 sq.ft
Mast length [max.] from waterline excl. Windex	22,00 m	72,18
I	18,40 m	60,36 ft
J	5,25 m	17,22 ft
P	17,70 m	58,07 ft
E	6,03 m	19,78 ft
Cabins	3/5	3/5
Head	2/4	2/4
CE category	A10 / B14 / C16	A10 / B14 / C16
Design	Cossutti Yacht Design	

BASE PRICE EX WORKS [EXCL. VAT] - C45 HOLIDAY	279.900,00 €
BASE PRICE EX WORKS [EXCL. VAT] - C45 STYLE	289.950,00 €

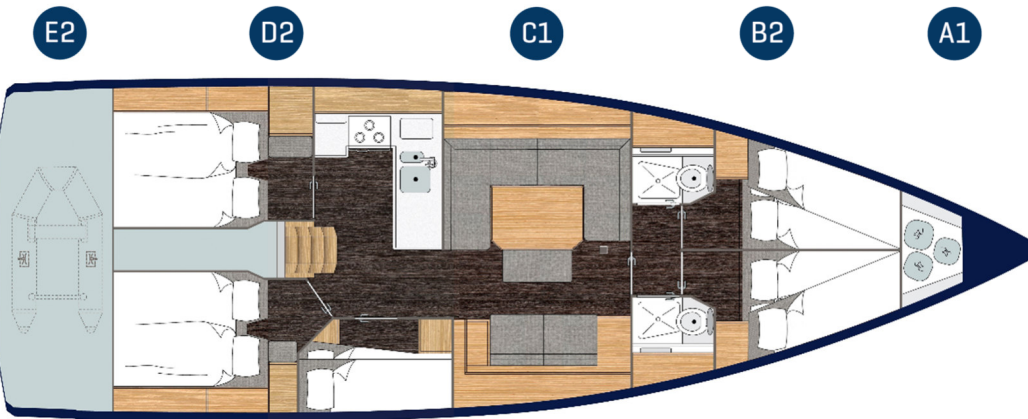
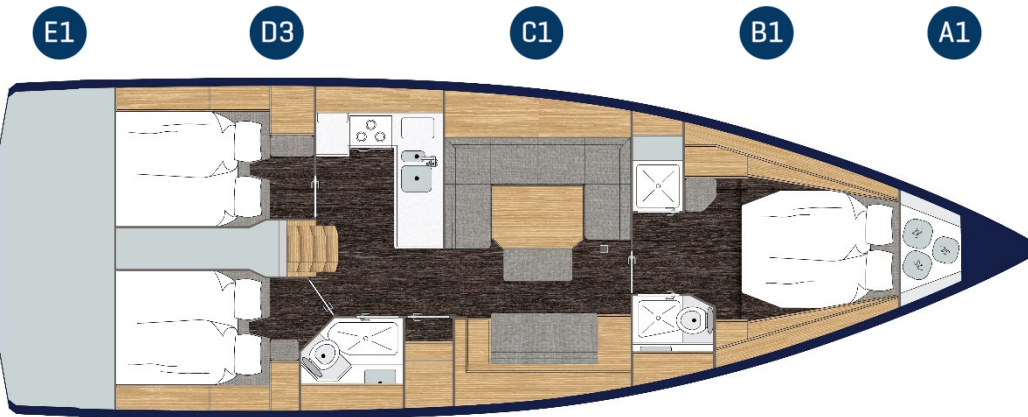
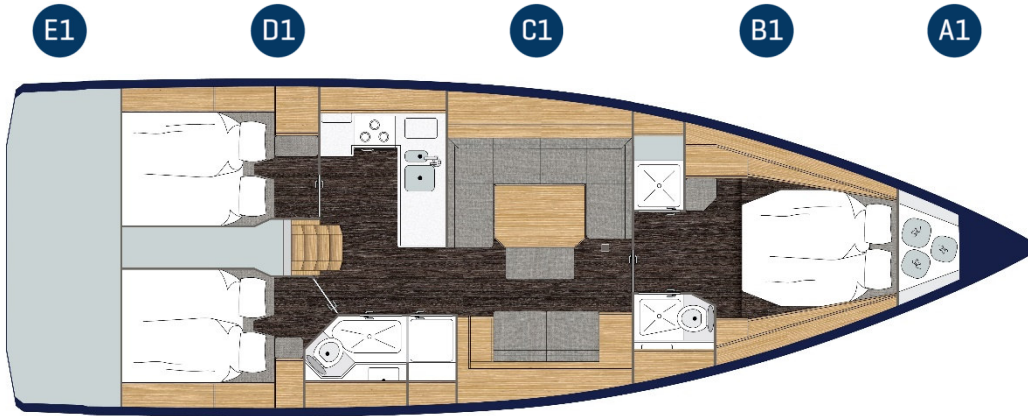

TRIM LEVEL EQUIPMENT	HOLIDAY	STYLE	C45
INTERIOR STYLING			
Headboard, fabric covered, in forward cabin (B1)		■	
Bed frames, fabric covered, in front and aft cabins		■	
Ceiling panels, fabric covered, in salon		■	
Chart table, leather covered		■	
Handrails, stainless steel, leather covered		■	
COCKPIT & DECK			
Cockpit table, stainless steel frame, foldable	■		
Cockpit table, 2 x, foldable and lowerable		■	
Rope storage boxes, at helm position		■	
INTERIOR EQUIPMENT			
Reading lights incl. USB charger, salon and cabins		■	
Handrail on ceiling in stainless steel with leather cover		■	

OPTIONAL PACKAGES		HOLIDAY	STYLE	Price excl. VAT	C45
SAIL READY PACK "HOLIDAY" (HP)					
PACKAGE CONTENTS		○	—	13.380,00 €	<input type="checkbox"/>
Battery extension, additional service battery, 2 x battery 95 Ah / 12 V, AGM incl. charger 60 A [instead of charger 40 A]	LED lights in salon and cabins				
Guard rail exit, both sides	Mooring kit [6 fenders and 4 mooring lines]				
Anchor windlass, electrical	Reading lights incl. USB charger, salon and cabins				
Anchor, 20 kg, incl. chain [10 mm, 75 m], galvanized	Handrail on ceiling in stainless steel				
Courtesy lights in salon	Rope storage boxes, bb and stb at helm position				
Curtains for coachroof and hull windows	Stainless steel bow protection				
Blinds incl. mosquito nets for hatches in salon and cabins	Cockpit shower with cold and warm water				
Deck vents, 2 x, on deck hatches					
UPGRADES SAIL READY PACK "HOLIDAY" (HP)					
Bow thruster, tunnel, incl. additional battery 2 x 95 Ah / 12 V, AGM		○	—	8.190,00 €	<input type="checkbox"/>
Anchor, 20 kg, incl. chain [10 mm, 75 m] stainless steel		○	—	4.560,00 €	<input type="checkbox"/>
Anchor windlass with capstans		○	—	1.350,00 €	<input type="checkbox"/>
SAIL READY PACK "STYLE" (SP)					
PACKAGE CONTENTS		—	○	25.740,00 €	<input type="checkbox"/>
Bow thruster, tunnel, incl. additional battery 2 x 95 Ah / 12 V, AGM	Curtains for coachroof and hull windows				
Teak on cockpit bottom	Blinds incl. mosquito nets for hatches in salon and cabins				
Battery extension, additional service battery, 2 x battery 95 Ah / 12 V, AGM incl. charger 60 A [instead of charger 40 A]	Deck vents, 2 x, on deck hatches				
Guard rail exit, both sides	LED lights in salon and cabins				
Anchor windlass, electrical	Mooring kit [6 fenders and 4 mooring lines]				
Anchor, 20 kg, incl. chain [10 mm, 75 m], galvanized	Ambient lights in salon and cabins, dimmable				
Courtesy lights in salon and cockpit	Extractor hood in galley				
	Cockpit shower with cold and warm water				
UPGRADES SAIL READY PACK "STYLE" (SP)					
Bow thruster, retractable, incl. additional battery 2 x 95 Ah / 12 V, AGM		—	○	6.780,00 €	<input type="checkbox"/>
Esthec on cockpit bottom		—	○	660,00 €	<input type="checkbox"/>
Anchor, 20 kg, incl. chain [10 mm, 75 m] stainless steel		—	○	4.560,00 €	<input type="checkbox"/>
Anchor windlass with capstans		—	○	1.350,00 €	<input type="checkbox"/>
NAVIGATION PACKAGES					
NAVIGATION "BASIC" PACKAGE (ONLY IN COMBINATION WITH GRP COCKPIT TABLE)		○	—	6.670,00 €	<input type="checkbox"/>
Display, 2 x B&G Triton ² digital displays in cockpit; B&G Wind vane; DST800 Transducer for speed, depth and temperature	VHF, B&G V60 with integrated AIS Receiver at chart table				
Multi function display, B&G Zeus ³ S 7" with integrated GoFree™ Wi-Fi; all-weather touch screen and expanded keypad at cockpit table					
NAVIGATION "ADVANCED" PACKAGE					
		○	○	16.060,00 €	<input type="checkbox"/>
Instrument console [1 x per helm station]	VHF, B&G V60 with integrated AIS Receiver at chart table				
Display, 2 x B&G Triton ² digital displays in cockpit	VHF, B&G H60 wireless handset				
B&G Wind vane	Autopilot B&G, incl. compass				
DST800 Transducer for speed, depth and temperature	Autopilot B&G, control unit at helm station stb				
Multi function display, 2 x B&G Zeus ³ S 9" with integrated GoFree™ Wi-Fi; all-weather touch screen and expanded keypad, one per helmstation	Autopilot B&G, wireless remote control WR10				
NAVIGATION "PREMIUM" PACKAGE					
		—	○	25.390,00 €	<input type="checkbox"/>
Instrument console [1 x per helm station]	VHF, B&G V60 with integrated AIS Receiver at chart table				
Display, 2 x B&G H5000 graphic displays [1 x per helmstation];	VHF, B&G H60 wireless handset				
B&G Wind vane	Autopilot B&G, incl. compass				
DST800 Transducer for speed, depth and temperature	Autopilot B&G, H5000 controll unit [1 x per helmstation]				
Multi function display, 2 x B&G Zeus ³ S 9" with integrated GoFree™ Wi-Fi; all-weather touch screen and expanded keypad, one per helmstation	Autopilot B&G, Hydra computer				
NMEA engine information interface for chart plotter	Autopilot B&G, wireless remote control WR10				
	Wifi router Locomarine, Micro 5s				
UPGRADES NAVIGATION PACKAGE					
Multi function display, B&G Zeus ³ S 9" with integrated GoFree™ Wi-Fi; all-weather touch screen and expanded keypad, at chart table		○	○	3.630,00 €	<input type="checkbox"/>
Radar B&G Halo 20+		○	○	3.840,00 €	<input type="checkbox"/>
Depth sounder, B&G ForwardScan		—	○	1.760,00 €	<input type="checkbox"/>
AIS transponder, B&G NAIS-500 class B transponder		○	○	1.530,00 €	<input type="checkbox"/>
NMEA engine information interface for chart plotter [included in Navigation "Premium" Package]		○	○	1.280,00 €	<input type="checkbox"/>
ENTERTAINMENT PACKAGE					
PACKAGE CONTENTS		○	○	2.980,00 €	<input type="checkbox"/>
Radio entertainment system Fusion MS-RA770 Apollo Marine with DAB+ and 2 speakers in salon	Fusion ERX400 Apollo remote control with 2 speakers in cockpit				
UPGRADES ENTERTAINMENT PACKAGE					
ENTERTAINMENT PACKAGE "OWNER"					
Radio entertainment system Fusion MS-RA210 with DAB+ and 2 speakers in foreship cabin [only with B1]		—	○	1.230,00 €	<input type="checkbox"/>
TV preparation in salon, incl. TV lift system		○	○	1.880,00 €	<input type="checkbox"/>

INDIVIDUAL OPTIONS		HOLIDAY	STYLE	Price excl. VAT	C45
HULL / KEEL					
STANDARD					
Hull in sandwich construction		Keel, L-shape, cast iron, draft 2,20 m			
OPTIONS					
Hull colour, white	■	■	Standard	<input type="checkbox"/>	
Hull colour silk grey with hull stripe white	○	○	5.210,00 €	<input type="checkbox"/>	
Hull stripe, dark blue	■	○	1.070,00 €	<input type="checkbox"/>	
Hull stripe, silk grey	○	■	1.070,00 €	<input type="checkbox"/>	
Hull stripe, dark grey	○	○	1.070,00 €	<input type="checkbox"/>	
Hull stripe, jet black	○	○	1.070,00 €	<input type="checkbox"/>	
Keel, L-shape, cast iron, draft 1,75 m	○	○	3.450,00 €	<input type="checkbox"/>	
PROPULSION & STEERING SYSTEM					
STANDARD					
Diesel engine, 42 kW / 57 hp, sail drive		Twin wheel steering system			
3 blade fixed propeller		GRP single rudder with aluminum stock			
Engine throttle, mechanical, mounted on helm station starboard		Steering wheel, stainless steel with leather cover			
OPTIONS					
Diesel engine, 59 kW / 80 hp, sail drive	○	○	5.570,00 €	<input type="checkbox"/>	
Propeller, folding, 3 blades	○	○	2.360,00 €	<input type="checkbox"/>	
Stern thruster incl. 2 x 95 Ah battery, retractable (only with bow thruster retractable)	—	○	15.750,00 €	<input type="checkbox"/>	
Steering wheel, composite, black or white	○	○	1.870,00 €	<input type="checkbox"/>	
Steering wheels covers	—	○	640,00 €	<input type="checkbox"/>	
STANDING AND RUNNING GEAR					
STANDARD					
Sportmast, deck stepped, 2 spreader, aluminum		Midboom sheeting system			
Jib furling system, above deck, manual		Elvström Cruisetech Dacron - Mainsail, short battened with 2 reefs - self tacking jib, no battens			
Rod kicker		Halyard winches, 2 x, size 50, manual			
Backstay adjuster, mechanical					
OPTIONS SPORTMAST					
Elvström Cruisetech Dacron - Mainsail, full battened with 2 reefs and MDS slider (replacing standard main sail)	○	○	1.420,00 €	<input type="checkbox"/>	
Elvström Duratech Dacron - Mainsail, full battened with 2 reefs and MDS slider- self tacking jib, no battens	○	—	8.860,00 €	<input type="checkbox"/>	
Elvström Sporttech laminate - Mainsail, full battened with 2 reefs and MDS slider- self tacking jib, vertical battened	○	○	11.520,00 €	<input type="checkbox"/>	
Lazy bag with lazy jacks for mainsail	○	○	1.680,00 €	<input type="checkbox"/>	
OPTIONS FURLING MAST					
Furling mast on deck stepped 2 spreader, aluminum incl. upgrade to Cruisetech Dacron furling mainsail	○	○	3.440,00 €	<input type="checkbox"/>	
Intracoastal Waterway Rigging: Short-mast and mainsail furling system incl. upgrade to Cruisetech Dacron furling mainsail	○	○	4.420,00 €	<input type="checkbox"/>	
Elvström Duratech Dacron - furling mainsail, no battens - self tacking jib, no battens	○	—	7.640,00 €	<input type="checkbox"/>	
Elvström Sporttech laminate - furling mainsail, full battened - self-tacking jib with vertical battens	○	○	11.220,00 €	<input type="checkbox"/>	
OPTIONS STANDING AND RUNNING GEAR					
Elvström genoa 106% - Cruisetech Dacron (only with genoa tracks)	○	○	4.100,00 €	<input type="checkbox"/>	
Elvström genoa 106% - Duratech (only with genoa tracks)	○	—	4.880,00 €	<input type="checkbox"/>	
Elvström genoa 106% - Sporttech (only with genoa tracks)	—	○	6.740,00 €	<input type="checkbox"/>	
Genoa tracks with pin stop cars	○	○	1.590,00 €	<input type="checkbox"/>	
Elvström gennaker incl. snuffer and gennaker gear (halyard, sheets, blocks, halyard clutch and pad eye)	○	○	6.750,00 €	<input type="checkbox"/>	
Elvström Code 0 incl. Selden CX furling system and gear (halyard, sheets, blocks, halyard clutch and pad eye for code 0 tack / only with bowsprit)	—	○	7.850,00 €	<input type="checkbox"/>	
Mast step	○	○	740,00 €	<input type="checkbox"/>	
Spreader lights, 4 pcs.	—	○	1.660,00 €	<input type="checkbox"/>	
GRP bowsprit (black or white / recommended for gennaker and code 0)	—	○	3.180,00 €	<input type="checkbox"/>	
OPTIONS WINCHES					
Halyard winches, 2 x, size 50, electrical	○	○	5.890,00 €	<input type="checkbox"/>	
Genoa/gennaker/code0 winches, 2 x, size 50, manual	○	○	1.520,00 €	<input type="checkbox"/>	
Genoa/gennaker/code0 winches, 2 x, size 50, electrical	—	○	5.890,00 €	<input type="checkbox"/>	
DECK FLOORING					
STANDARD					
Teak on cockpit benches and bathing platform					
OPTIONS					
Teak on cockpit bottom	○	○	4.840,00 €	<input type="checkbox"/>	SP
Teak on side decks	○	○	16.970,00 €	<input type="checkbox"/>	
Teak on coachroof	—	○	6.400,00 €	<input type="checkbox"/>	
Esthec on cockpit benches and bathing platform	○	○	540,00 €	<input type="checkbox"/>	
Esthec on cockpit bottom	○	○	5.310,00 €	<input type="checkbox"/>	
Esthec on side decks	○	○	17.060,00 €	<input type="checkbox"/>	
Esthec on coachroof	—	○	6.250,00 €	<input type="checkbox"/>	

INDIVIDUAL OPTIONS		HOLIDAY	STYLE	Price excl. VAT	C45
COCKPIT & DECK					
STANDARD					
Deck in sandwich construction, cockpit floor, side decks and coach roof with non-slip structure Deck flush hatches	Dedicated life raft storage in cockpit floor Bow fitting with anchor roller, stainless steel Mooring cleats, 6 x, stainless steel, fix				
OPTIONS COCKPIT & DECK					
Cockpit table, removable	—	—	on request	<input type="checkbox"/>	
GRP cockpit table with storage, foldable	○	○	2.430,00 €	<input type="checkbox"/>	
Drawer fridge incl. compressor at wet bar, 20 L [only in combination with E2 and BBQ/sink]	○	○	1.690,00 €	<input type="checkbox"/>	
BBQ [gas] and sink/water tab in wet bar [only in combination with E2]	○	○	2.620,00 €	<input type="checkbox"/>	
Guard rail exit, both sides	○	○	1.310,00 €	<input type="checkbox"/>	HP, SP
Mooring cleats, 6 x, aluminum, retractable	—	○	4.160,00 €	<input type="checkbox"/>	
Stainless steel bow protection	○	○	530,00 €	<input type="checkbox"/>	HP
OPTIONS COCKPIT UPHOLSTERY					
Cockpit cushions incl. backrests	—	○	3.310,00 €	<input type="checkbox"/>	
Cockpit cushions for lowerable tables	—	○	520,00 €	<input type="checkbox"/>	
Cockpit cushions	○	○	1.960,00 €	<input type="checkbox"/>	
Sun bed cushions on coachroof incl. headrest and cup holders	○	○	1.940,00 €	<input type="checkbox"/>	
Sun bed cushions on foredeck incl. headrest and cup holders	○	○	2.040,00 €	<input type="checkbox"/>	
OPTIONS HOODS					
Bimini top	○	○	4.490,00 €	<input type="checkbox"/>	
Sprayhood with handhold	○	○	2.720,00 €	<input type="checkbox"/>	
Cockpit tables cover [only with GRP cockpit table and double cockpit table]	—	○	670,00 €	<input type="checkbox"/>	
BATHING PLATFORM					
STANDARD					
Bathing platform, electric					
OPTIONS					
Wireless remote control for bathing platform	○	○	1.580,00 €	<input type="checkbox"/>	
12 V air compressor at transom for dinghy or toys [only with E2 Layout]	○	○	920,00 €	<input type="checkbox"/>	
INTERIOR LAYOUT					
STANDARD					
A1: Sail locker B1: Queen size "island" double berth, storage, separate head and shower stall C1: Salon incl. L shaped galley, dining area on port, lounge area and chart table on stb	D3: 2 twin cabins aft incl. head and utility room on stb E1: Storage space for toys and equipment under cockpit, access via cockpit floor hatch Companion way with washboard and sliding hatch in acrylic glass, lockable Salon dining table				
OPTIONS					
B2: 2 Forward cabin, each cabin with bunk bed and storage, flex bulkhead system, 2 heads	○	○	6.820,00 €	<input type="checkbox"/>	
D1: 2 Aft cabins, incl. head with separate shower stall on stb	○	○	2.100,00 €	<input type="checkbox"/>	
D2: 2 Aft cabins, incl. bunk bed cabin on stb [only with B2 layout]	○	○	2.440,00 €	<input type="checkbox"/>	
E2: Dinghy garage with integrated transom bench and storage/wetbar [for wetbar choose option BBQ/watertap]	○	○	4.110,00 €	<input type="checkbox"/>	
Salon table, lowerable, electrical, convertible into double berth incl. cushion, electrical	○	○	2.490,00 €	<input type="checkbox"/>	
INTERIOR STYLING					
STANDARD					
Wood color, Mahogany Floor, Elm Worktop in galley, laminated, "Brown stone"	Upholstery "Vela" in salon Standard mattresses for all berths				
OPTIONS STYLING					
Wood color, Mahogany	■	■	Standard	<input type="checkbox"/>	
Wood color, American Walnut	○	○	5.990,00 €	<input type="checkbox"/>	
Wood color, Nordic Oak	○	○	6.470,00 €	<input type="checkbox"/>	
Floor, Elm	■	■	Standard	<input type="checkbox"/>	
Floor, Wenge	○	○	730,00 €	<input type="checkbox"/>	
Floor, Ocean Line	○	○	1.060,00 €	<input type="checkbox"/>	
Worktop in galley, laminated, "Pure white stone"	○	—	400,00 €	<input type="checkbox"/>	
Worktop in galley, solid worktop "Gravel"	—	○	2.030,00 €	<input type="checkbox"/>	
Worktop in galley, solid worktop "Chrispy Milk"	—	○	2.260,00 €	<input type="checkbox"/>	
OPTIONS UPHOLSTERY					
Upholstery "Opus" in salon, artificial leather	○	○	1.310,00 €	<input type="checkbox"/>	
Upholstery "Savoy" in salon, leather	—	○	5.610,00 €	<input type="checkbox"/>	
Cold foam mattress with memory top for all berths 3 cabins	○	○	3.460,00 €	<input type="checkbox"/>	
Cold foam mattress with memory top for all berths 4 cabins	○	○	3.680,00 €	<input type="checkbox"/>	
Cold foam mattress with memory top for all berths 5 cabins	○	○	3.890,00 €	<input type="checkbox"/>	

INDIVIDUAL OPTIONS		HOLIDAY	STYLE	Price excl. VAT	C45
INTERIOR EQUIPMENT - GALLEY					
STANDARD					
Fridge in galley, 110L, top loading		3 burner stove with oven			
OPTIONS					
Microwave, 230 V		<input type="radio"/>	<input type="radio"/>	780,00 €	<input type="checkbox"/>
Microwave preparation, 110V		<input type="radio"/>	<input type="radio"/>	410,00 €	<input type="checkbox"/>
Dishwasher drawer 230 V		<input type="radio"/>	<input type="radio"/>	3.510,00 €	<input type="checkbox"/>
Additional drawer fridge incl. Freezer unit totalling 160 L		<input type="radio"/>	<input type="radio"/>	3.660,00 €	<input type="checkbox"/>
Extractor hood in galley		—	<input type="radio"/>	880,00 €	<input type="checkbox"/>
INTERIOR EQUIPMENT - ELECTRICAL SYSTEM					
STANDARD					
Country version EU		Service battery, 2 x 95 Ah / 12 V, AGM			
230 V socket in each cabin		Battery charger, 40 Ah [3 channels]			
Engine battery, 1 x 96 Ah / 12 V, AGM		Shore power 230 V			
OPTIONS					
Inverter 2.500 W, 230 V [true sine wave]		<input type="radio"/>	<input type="radio"/>	3.070,00 €	<input type="checkbox"/>
Inverter 2.000 W, 110 V [true sine wave]		<input type="radio"/>	<input type="radio"/>	3.070,00 €	<input type="checkbox"/>
Diesel generator 6.4 kW, 230 V		<input type="radio"/>	<input type="radio"/>	23.740,00 €	<input type="checkbox"/>
Diesel generator 6.4 kW, 110 V		<input type="radio"/>	<input type="radio"/>	28.190,00 €	<input type="checkbox"/>
Shore power 110 V		<input type="radio"/>	<input type="radio"/>	3.400,00 €	<input type="checkbox"/>
INTERIOR EQUIPMENT - WATER					
STANDARD					
40 L boiler		Electric and manual bilge pump			
70 L holding tank, per toilet					
OPTIONS					
Fresh water dockside inlet		<input type="radio"/>	<input type="radio"/>	560,00 €	<input type="checkbox"/>
Washing machine, 220 V [only with D3 layout]		—	<input type="radio"/>	3.120,00 €	<input type="checkbox"/>
Electric toilet [1 x] front cabin with fresh water flush system for B1 layout		<input type="radio"/>	<input type="radio"/>	1.250,00 €	<input type="checkbox"/>
Electric toilet [2 x] front cabin with fresh water flush system for B2 layout		<input type="radio"/>	<input type="radio"/>	2.490,00 €	<input type="checkbox"/>
Electric toilet [1 x] aft cabin with fresh water flush system for D1 or D3 layout		<input type="radio"/>	<input type="radio"/>	1.250,00 €	<input type="checkbox"/>
Grey water system, totalling 244 L [reduces fresh water capacity to 345 L]		<input type="radio"/>	<input type="radio"/>	2.110,00 €	<input type="checkbox"/>
INTERIOR EQUIPMENT - CLIMATE CONTROL (HEATING AND AIR CONDITIONER ARE NOT COMBINABLE)					
OPTIONS					
Air Conditioner, Reverse Cycle, 16.000 BTU, 2 Units for foreship cabin and aft cabins, incl. 2nd shore power, 230V / 110V		<input type="radio"/>	<input type="radio"/>	15.990,00 €	<input type="checkbox"/>
Air Conditioner, Reverse Cycle, 16.000 BTU, 1 Unit for salon (incl. D2 cabin), incl. 2nd shore power, 230V / 110V		<input type="radio"/>	<input type="radio"/>	13.100,00 €	<input type="checkbox"/>
Hot air heating, 8,0 kW, 2 Units for salon, foreship cabin[s] and aft cabins		<input type="radio"/>	<input type="radio"/>	9.060,00 €	<input type="checkbox"/>
SHIPMENT					
OPTIONS					
Keel not mounted		<input type="radio"/>	<input type="radio"/>	630,00 €	<input type="checkbox"/>
Steel cradle for oversea transport		<input type="radio"/>	<input type="radio"/>	5.530,00 €	<input type="checkbox"/>
Steel cradle for oversea transport without keel [only with keel not mounted]		<input type="radio"/>	<input type="radio"/>	8.080,00 €	<input type="checkbox"/>
Shrink wrap		<input type="radio"/>	<input type="radio"/>	1.070,00 €	<input type="checkbox"/>

— Not available ■ Standard ○ Optional

Bavaria Yachtbau GmbH, Bavariastraße 1, D-97232 Giebelstadt, Phone +49 9334 942-0, Fax +49 9334 942-1160, www.bavariayachts.com, info@bavariayachts.com

All prices are in EURO and are valid only in conjunction and at the time of ordering a new yacht ex works Giebelstadt. All measurements and weights are calculations based upon design documents. The brochure is intended for advertisement only and is not part of a contract, warranty or of any offer. We reserve the right to modify or improve our products and to change specifications without notice. We reserve the right to replace the brands/manufacturers mentioned in the price list with equivalent products from other reputable manufacturers. We are not liable for errors and printing mistakes. Aforementioned prices are recommended sales prices for deliveries ex works within 4 months of order placement. Later deliveries are subject to invoicing according to the then valid price list.

Version: 2/2023

Valid from 15th December 2022

Publication: 15th December 2022 – The previous price list loses its validity.

Language/Taxes: English pricelist/all prices excl. VAT

